

QUEST 225

INTAKE DUCT INSTALLATION GUIDE

AIR CAN BE DISTRIBUTED FROM THE UNIT IN TWO WAYS:

1 USE RECTANGULAR DUCT.

- REMOVE THE FILTER FROM THE UNIT AND SET ASIDE. THIS WILL BE RE-USED AFTER THE DUCTING IS INSTALLED.
- ATTACH INTAKE DUCT PLENUM (**ITEM 3**) TO QUEST 225 AIR INTAKE USING SIX #10-24 SHEET METAL SCREWS (FOUR FROM DUCT KIT, TWO EXISTING FROM THE RIGHT SIDE OF UNIT).
- LOOSEN THE TWO SCREWS ON THE RIGHT SIDE OF THE UNIT (DO NOT REMOVE) TO FIT THROUGH THE KEYHOLE SLOT THEN TIGHTEN DOWN. REMEMBER TO RETAIN THESE SCREWS FOR FUTURE RE-USE.
- OPEN AND REMOVE FILTER DOOR (**ITEM 3**).
- SLIDE FILTER INTO INTAKE DUCT PLENUM (**ITEM 3**).
- INSTALL FILTER DOOR (**ITEM 3**) OVER FILTER OPENING IN INTAKE DUCT PLENUM (**ITEM 3**).
- ATTACH RECTANGULAR DUCTING (NOT INCLUDED) DIRECTLY TO INTAKE DUCT PLENUM (**ITEM 3**).

2 USE 1-14" ROUND DUCT.

- REMOVE THE FILTER FROM THE UNIT AND SET ASIDE. THIS WILL BE RE-USED AFTER THE DUCTING IS INSTALLED.
- ATTACH INTAKE DUCT PLENUM (**ITEM 3**) TO QUEST 225 AIR INTAKE USING SIX #10-24 SHEET METAL SCREWS (FOUR FROM DUCT KIT, TWO EXISTING FROM THE RIGHT SIDE OF UNIT).
- LOOSEN THE TWO SCREWS ON THE RIGHT SIDE OF THE UNIT (DO NOT REMOVE) TO FIT THROUGH THE KEYHOLE SLOT OF PLENUM, THEN TIGHTEN BACK DOWN. REMEMBER TO RETAIN THESE FOR FUTURE RE-USE.
+ REFERENCE SAFE ZONE IMAGE IN MANUAL (SECTION 4.5) IF UNSURE OF FASTENER LOCATIONS.
- OPEN AND REMOVE FILTER DOOR (**ITEM 3**)
- SLIDE FILTER INTO INTAKE DUCT PLENUM (**ITEM 3**).
- INSTALL FILTER DOOR (**ITEM 3**) OVER FILTER OPENING IN INTAKE DUCT PLENUM (**ITEM 3**).
- ATTACH 14" DIAMETER ROUND DUCT COLLAR (NOT PROVIDED) TO DUCT ADAPTER FACE (**ITEM 4**).

⚠ CAUTION WHEN DUCTING THE UNIT, A DEDICATED DUCT SYSTEM IS RECOMMENDED FOR EACH UNIT. RECOMMENDED 25' MAX RUN OF DUCTING.

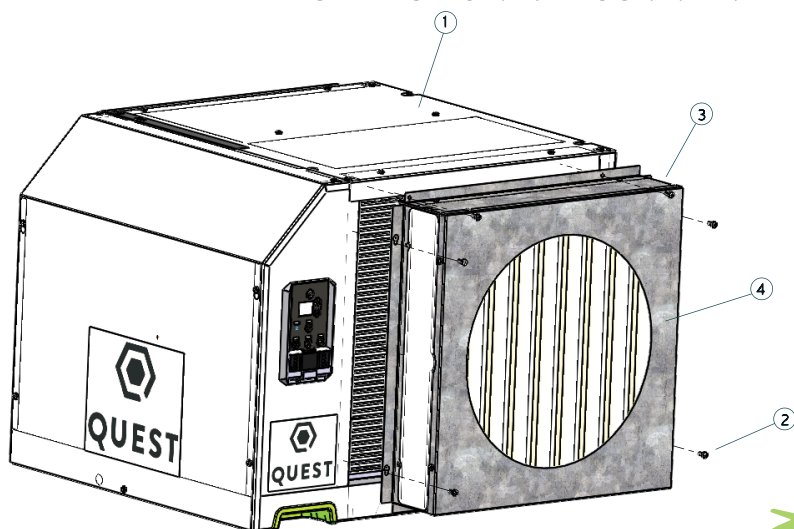

ITEM 1: Quest 225 Dehumidifier (*not provided*)

ITEM 2: #10-24 Panhead Torx Screws (6)

ITEM 3: Intake Duct Adapter (1)

ITEM 4: Duct Adapter Face (1)

ITEM 5: 14" Dia. Duct Collar (*not provided*)*

ITEM 6: 1/8" Drill Bit (*not provided*)*

* Available at any hardware or HVAC store



FOR MORE DETAILS, SCAN
ABOVE FOR THE 225 MANUAL.



1.877.420.1330
QUESTCLIMATE.COM

TS-1247
05/23 REV B

QUEST 225

EXHAUST DUCT INSTALLATION GUIDE

AIR CAN BE DISTRIBUTED FROM THE UNIT IN TWO WAYS:

1 USE RECTANGULAR DUCT.

- A. ATTACH EXHAUST DUCT PLENUM (ITEM 4) TO THE QUEST 225 AIR OUTLET USING SIX (6) #10-24 SHEET METAL SCREWS (FOUR FROM DUCT KIT, TWO FROM LEFT SIDE OF UNIT). REMEMBER TO RETAIN THE SCREWS FOR FUTURE RE-USE.
 - + REFERENCE THE "SAFE ZONE" DIAGRAM IN QUEST 225 MANUAL (SECTION 4.5) FOR FASTENER LOCATION.
- B. ATTACH RECTANGULAR DUCTING (NOT PROVIDED) DIRECTLY TO EXHAUST DUCT PLENUM (ITEM 4).

2 USE 1-14" ROUND DUCT.

- A. ATTACH EXHAUST DUCT PLENUM (ITEM 4) TO UNIT (ITEM 1) USING SIX (6) #10-24 SHEET METAL SCREWS (ITEM 2).
 - *TWO SCREWS FROM LEFT SIDE OF UNIT AND FOUR FROM DUCT KIT. REMEMBER TO RETAIN THESE FOR FUTURE RE-USE.
 - + REFERENCE THE "SAFE ZONE" DIAGRAM IN QUEST 225 MANUAL (SECTION 4.5) FOR FASTENER LOCATION.
- B. ATTACH 14" DIAMETER ROUND DUCT TO EXHAUST DUCT PLENUM FACE (ITEM 3).

CAUTION

WHEN DUCTING THE UNIT, A DEDICATED DUCT SYSTEM IS RECOMMENDED FOR EACH UNIT. RECOMMENDED 25' MAX RUN OF DUCTING.

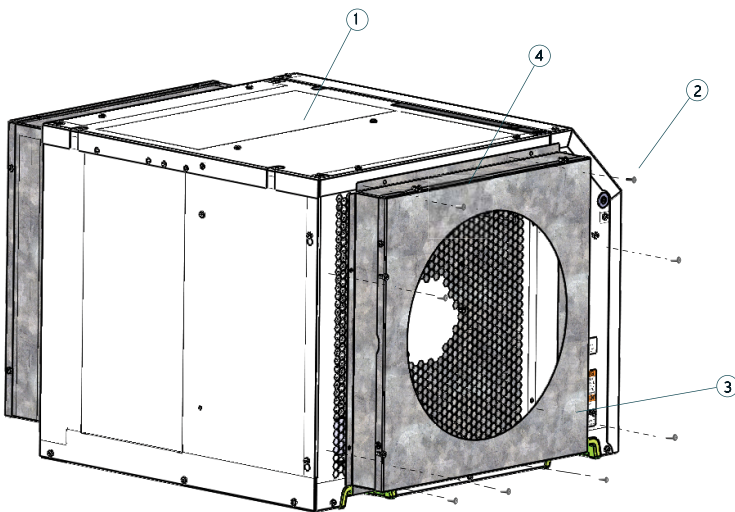

ITEM 1: Quest 225 Dehumidifier (*not provided*)

ITEM 2: #10-24 Panhead Torx Screws (6)

ITEM 3: Duct Plenum Face (1)

ITEM 4: Exhaust Duct Plenum (1)

ITEM 5: 14" Dia. Duct Collar (*not provided*)*

ITEM 6: 1/8" Drill Bit (*not provided*)*

** Available at any hardware or HVAC store*



**FOR MORE DETAILS, SCAN
ABOVE FOR THE 225 MANUAL**